



PROJECT		REF		REV	ITEM CODE	
LOCATION		DATE			PAGE	

SANITARY WARE SPECIFICATION SHEET

Item Descriptions	GROHE (Germany) "Euroeco Special / SSC" Chrome plated single-lever safety basin mixer; comprising "Neoperl" flexible hose ref. 39.00CD.EFG.HI (General Acceptance No. B20190071); nominated flow rate 5 L/min in WELS Grade 1 ; Registration No. TM 20-0025; operating force of lever control less than 22N ; test report J24252C ; complied with Barrier Free Access 2008
Dimensions	Height: 167mm
Model	32789000 (Mixer) 403655031 (Aerator)
Material	Chrome Plated
Manufacturer	GROHE Limited
Supplier	Acme Sanitary Ware Co. Ltd Mr. Eric Wong/ Mr. Don Yuen
Contact Tel/Fax	(852) 2388-7171 / (852) 2710-8012
E-mail	acme@acmesanitary.com.hk
Website	www.acmesanitary.com.hk

Euroeco Special / SSC

Single-lever safety basin mixer 1/2"

- single hole installation
- smooth body
- **GROHE StarLight®** chrome finish
- **GROHE EcoJoy®** technology for less water and perfect flow
- ceramic cartridge
- adjustable flow rate limiter
- adjustable temperature limiter
- adjustable minimum flow rate 6 l/min.
- laminar flow straightener 9 l/min.
- metal lever
- lever length 120 mm
- rapid installation system
- flexible connection hoses

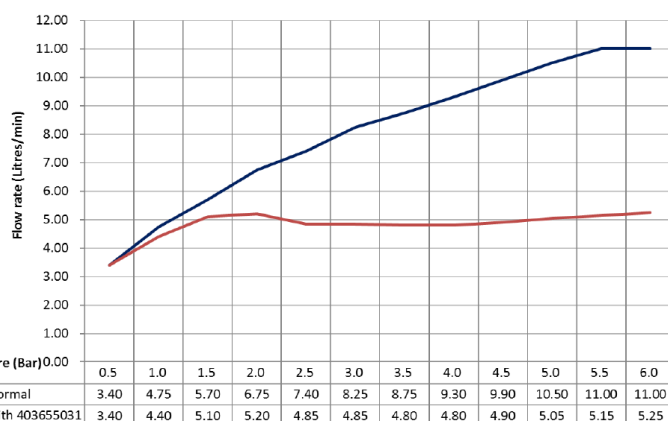

Illustration/ Drawing

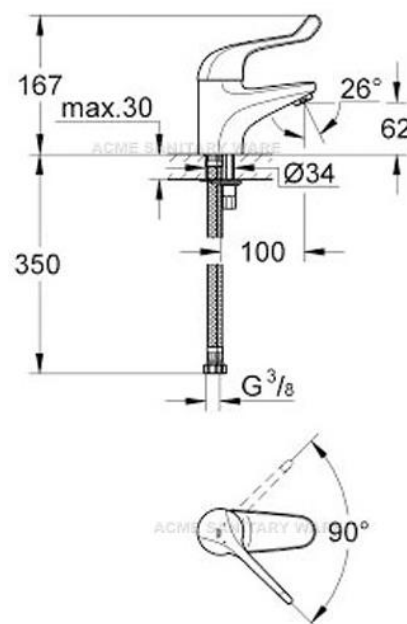

Note: Maximum flow rate: approximately 5 litres at 4 bar max - Orange (subject to change on requested for project)

* All information of the above is for the reference only. No prior notice is made if any changes.

註冊號碼 (Registration No.):

TM 20-0025



自願參與用水效益標籤計劃 - 水龍頭
Voluntary Water Efficiency Labelling Scheme - Water Taps



茲證明

This is to certify that

將下列水龍頭在本計劃內註冊：
has registered the following water tap under this scheme :

牌 子 / Brand	:	GROHE
型 號 / Model	:	32789XXX + 403655031
種 類 / Type	:	Mixing
原產地 / Country or Region Origin	:	Germany (Mixer & Flow Controller)

XXX = denotes colour variants

在用水效益標籤上展示的標誌 <i>Symbolic Presentation on the Water Efficiency Label</i>	:		滴水點 <i>Water droplet(s)</i>
用水效益級別 <i>Water Efficiency Grade</i>	:	1	
耗水量 <i>Water Consumption</i>	:	5	公升/分鐘 <i>litres/minute</i>

簽發日期：
Date of Issue: 20 March 2020



水務署
Water Supplies Department



水務署署長(張業駒代行)
for Director of Water Supplies



Department

香港灣仔道七號入境事務大樓 48 樓

48/F, Immigration Tower, 7 Gloucester Road, Wan Chai, Hong Kong

本署檔號 : (4) in WSD 3321/19 T/J(613/2019)
Our ref.

來函檔號 :
Your ref.

電話 :
Tel.
傳真 : 2824 0578
Fax.

20 August 2019

Approval of "GROHE" Basin Mixer (General Acceptance No. C20190424)

Your letters ref. WRC/2085 and C-WSD/0519 dated 24 June 2019 and 9 August 2019 respectively refer.

Having considered the test report ref. J24252Ar1 issued on 9 July 2019 by Nutek Systems (HK) Ltd., this Authority accepts that the fitting described below complies with, and its use when correctly installed does not contravene, the Waterworks Ordinance and Regulations.

Name of Manufacturer: Grohe AG

Country of Origin: Germany

Brand: Grohe

Details of Fitting: 3/8" Single lever basin mixer

Model: 32789XXX
(where the digits "XXX" denote the code of colour)

Body Markings: **GROHE**

Expiry Date: 27 May 2024



This Authority hereby permits the use of the above fitting in fresh water plumbing systems subject to full adherence to Waterworks installation requirements. In particular, you are required to draw your customers' attention to the following requirement-

"The cold water supply to the fitting shall be drawn from the same source that supplies the hot water apparatus so as to provide a balanced pressure and to obviate the risk of scalding in the event of a restriction or failure in the water supply."

A condition of this acceptance is that the fitting to be installed shall be replicas of the sample as certified by the testing agent mentioned above and without modifications. This acceptance may be withdrawn at any time if the standard of the fitting installed fails to meet that of the approved sample or if the fitting is found to be unsuitable for use in fresh water plumbing systems.

This acceptance is only applicable to the main body of the fitting, unless otherwise specified.

For the use of the fitting in any project, the General Acceptance Number of this letter must be quoted as a means of identification of acceptance of the fitting by this Authority.

Should you have any enquiries, please contact our Engineer Mr. Terry KUNG at tel. no. 3583 4086.

Yours faithfully,



(CHAN Chung-kun)

for Director of Water Supplies

Encl.

c.c. WSD 3321/1/82] - without catalogue
 ME/MC] - with soft copy only



Department

入境事務大樓 48 樓
48/F, Immigration Tower, 7 Gloucester Road, Wan Chai, Hong Kong

本署檔號 : (8) in WSD 3321/19 T/J(961/2019)
Our ref.
來函檔號 :
Your ref.

電話 :
Tel.
傳真 : 2824 0578
Fax.

24 December 2019

Approval of "NEOPERL" Flexible Hose (General Acceptance No. B20190071)

Your letter ref. 010/kl dated 12 September 2019 and subsequent submissions received by this department up to 9 December 2019 refer.

It is noted that the fitting described below has been accepted by the United Kingdom Water Regulations Advisory Scheme (WRAS) to have complied with the requirements of the United Kingdom Water Supply (Water Fittings) Regulations / Scottish Water Byelaws when correctly installed. This Authority accepts that the fitting described below based on the WRAS certificate complies with, and its use when correctly installed does not contravene, the Waterworks Ordinance and Regulations.

Name of Manufacturer: Neoperl GmbH

Country of Origin: Germany

Brand: Neoperl

Details of Fitting: Range of polyamide (PA) braided PEX lined flexible hose assemblies with brass end connections, EPDM washers and fibre washers. Maximum working pressure 10.0 bar. Maximum operating temperature 70°C.



Model:	39.00CD.EFG.HI (where CD.EFG = hose specification including fitting specification (00.000 – 99.999) and HI = Packaging information (0-9))
Size:	Bore diameters: DN6 & DN8 End connections: Female elbow (BSP captive nut): 3/8", 1/2", 3/4" Female (BSP captive nut): 3/8", 1/2", 3/4" Tube: 10mm to 12mm Male (BSP): M10 to M15 Male (BSP): 3/8", 1/2", 3/4" Comp. joint: ø10 - ø15 Plugin: D10- D13
Body Markings:	Neoperl, Softpex, WRAS and date of manufacture (YYMMDD) on crimped connector

WRAS Approval Number: 1904348

Installation Requirements: R001, R008

Expiry Date: 30 April 2024

In view of the acceptance by WRAS, this Authority has no objection to the use of the said fitting in fresh water plumbing systems subject to full adherence to Waterworks installation requirements. In particular, you are required to draw your customers' attention to the following installation requirements –

“Installation shall comply with the ‘Installation Requirements & Notes’ of the WRAS’s approval letter concerned.” AND

“The inlet flexible hose is applied for the water tap or mixer connection only and installed in the fresh water plumbing systems.”

A condition of this acceptance is that the fitting to be installed should be replicas of the sample certified by WRAS and no modification should be made to the fitting. This acceptance may be withdrawn at any time if the standard of the fitting installed fails to meet that of the approved sample or if the fitting is found to be unsuitable for use in fresh water plumbing systems.

For the use of the fitting in any project, the General Acceptance Number of this letter must be quoted as a means of identification of acceptance of the fitting by this Authority.

Should you have any enquiries, please contact our Engineer Mr. Terry KUNG
at tel. no. 3583 4086.

Yours faithfully,



(CHAN Chung-kun)

for Director of Water Supplies

Encl.

c.c. WSD 3321/1/82] - without catalogue
 ME/MC] - with soft copy only



Nutek Sy
Tel: +852

Nutek Systems

Block A, Universal Industrial Centre, 23-25 Shan Mei Street, FO TAN, N.T., HONG KONG
2 0798 info@nuteksystems.com www.nuteksystems.com

Nutek Systems
I certify this to be a true copy
of the original document

Date : 07 MAY 2019

Signed:
Hazel Wong

Test Report

TITLE : Testing of Water Tap
REFERENCE NO. : J 24252C
DESCRIPTION OF SAMPLE¹ : 3/4" Single lever basin mixer
SAMPLE SUBMITTED BY¹ :

MANUFACTURER¹ : Grohe AG
BRAND¹ : GROHE
COUNTRY OF ORIGIN¹ : Germany
MODEL¹ : 32789XXX (XXX denotes colour variants)
(Refer to appendix A)
BODY MARKINGS :
PERIOD OF TESTS : 03 May, 2019

¹ – Information provided by client

RESULTS: (apply only to the sample tested)

SUMMARY OF RESULTS

Test	Remark
1 Operating force	C

1. OPERATING FORCE
BFA 2008 Cl. 51

Variable		Unit	Measured	Required	Remark
Operating Force	1st	Newton	13	≤ 22	C
	2nd		14		C
	3rd		13		C
Overall result					C

Date: 07 May, 2019

Authorized signature:

Nutek Systems is a testing agency,
accepted by the Water Supplies
Department, for testing water supply
fittings.

NG DICK TIK LUN
(Test Engineer)